

# Cutter Pumps

## SFC820...2320

Axial/semi-open impellers



### SFC820...1120

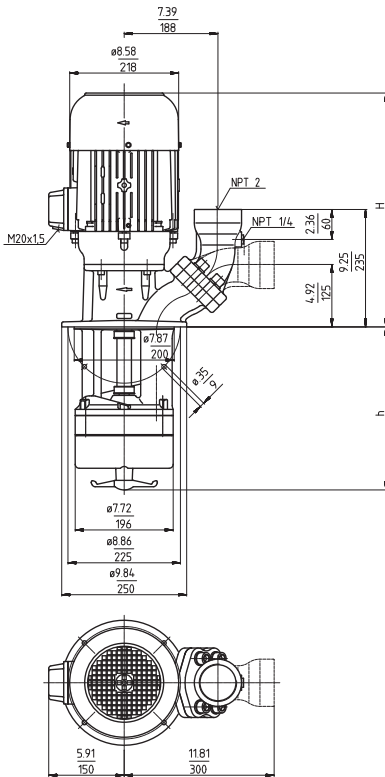

### SFC1520...2320

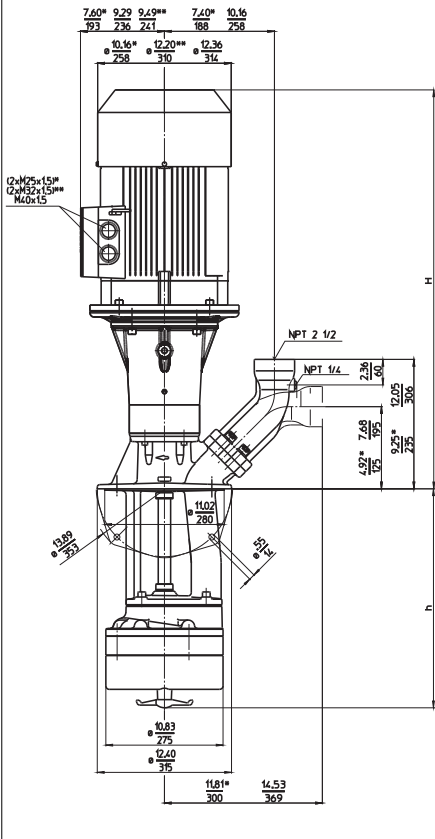

Type	Flow at head		Height	Depth of immersion		Weight		Power HP kW	Voltage 3~ V	Fre- quen- cy Hz	Current AMPS	Speed RPM
	GPM /Feet l/min /m	H inch mm	h inch h mm	Lbs kg								
<b>SFC820S290</b>	125/30	19.8	11.50 292	161.0	73	6.1	230	60	15.8	3520		
	400/10	503	15.43 392	168	76							
	520		20.55 522	172	78							
	640		25.28 642	179	81							
<b>SFC1120S290</b>	150/36	21.0	11.50 292	172	78	8.4	230	60	20.8	3510		
	500/12	533	15.43 392	179	81							
	520		20.55 522	187	85							
	640		25.28 642	194	88							
<b>SFC1520S370</b>	200/56	24.1	14.65 372	318	144	11.5	230	60	27.8	3550		
	700/18	612	19.76 502	329	149							
	620		24.49 622	337	153							
<b>SFC1820S370</b>	250/68	24.4	14.65 372	381	173	16.9	230	60	39.2	3560		
	850/23	620	19.76 502	388	176							
	620		24.49 622	397	180							
<b>SFC2320S400</b>	250/106	38.3	15.75 400	492	223	25	460	60	28	3560		
	900/32	974	20.87 530	501	227							
	650		25.59 650	514	233							

Dimensions in Inches / mm  
 \*) Dimensions SFC1820S  
 Discharge port with NPT 2 inches available upon request.  
 \*) Dimensions SFC1520S  
 \*\*) Dimensions SFC1820S



**Cutter Pumps**

The cutter pumps of the series SFC are suited for cutting aluminium chips or similar materials and for pumping these materials along with the coolant fluid. An agitator located at the pump suction helps to break up and separate any large bundles of chips or birds nests which reach the pump suction.

The hardened cutting unit (> 60HRC) is cutting chips and the semi-open impeller with its large clearances allows to pump the particles along with the coolant fluid from the machine back to the filter. The SFC pumps are capable of handling chip to coolant ratios of up to 1.5% by weight.

The SFC pumps are equipped with the user-friendly 45 degree flange connection which allows for either vertical or horizontal pipe connection and the connection of a pressure gauge.

For more information see mechanical features within the technical information section.



**Applications**

- Types of fluid
  - coolants
  - cooling/cutting oils on request
- Max. chip to coolant ratio by weight: 1.5 %
- Chip material: Aluminium
- Kinematic viscosity ...200 SSU (...45 mm<sup>2</sup>/s)
- Pumping temperature 30...175 °F (0...80 °C)

**Construction**

- |                 |                      |
|-----------------|----------------------|
| Pump body       | cast iron            |
| Cover           | cast iron            |
| Impeller radial | cast steel           |
| Cutting unit    | Hardened (>60 HRC)   |
| Agitator        | Highly ductile steel |
| Shaft           | steel                |

