

# Pressure Boosting Pumps

## FH11

### Closed impellers



#### FH1102...1115

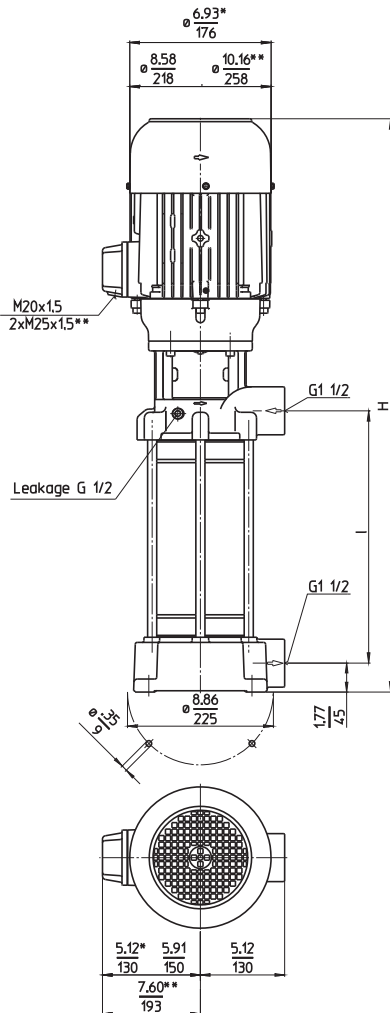

Dimensions in Inches / mm

\*) Dimensions FH1102...FH1104

\*\*) Dimensions FH1110...FH1115

Type	Flow at head		Height	Length		Weight		Power	Voltage	Fre-	Current	Speed
	GPM /Feet	l/min /m	H inch	l Inch	l mm	Lbs	kg	HP	V	quen-	AMPS	RPM
			mm					kW	3~	cy		
FH1102S18	37.5/100	150/30	25.3	8.3	212	86.0	39	2	230	60	5.4	3500
			643					1.49	460	60	2.7	3500
FH1103S18	37.5/150	150/45	27.6	8.3	212	101.4	46	2.9	230	60	7.8	3500
			702					2.18	460	60	3.9	3500
FH1104S28	37.5/200	150/59	31.4	12.1	308	103.6	47	3.9	230	60	10.2	3480
			798					2.94	460	60	5.1	3480
FH1105S28	37.5/250	150/77	33.0	12.1	308	132.3	60	5.1	230	60	12.8	3520
			837					3.8	460	60	6.4	3520
FH1106S28	37.5/300	150/90	33.0	12.1	308	136.7	62	6.1	230	60	15.8	3520
			837					4.55	460	60	7.9	3520
FH1107S31	37.5/355	150/106	35.4	13.4	340	147.7	67	7.7	230	60	19.0	3520
			899					5.75	460	60	9.5	3520
FH1108S38	37.5/400	150/121	37.9	15.9	404	152.1	69					
			963									
FH1109S38	37.5/455	150/138	37.9	15.9	404	156.6	71	8.4	230	60	20.8	3510
			963					6.3	460	60	10.4	3510
FH1110S47	37.5/510	150/152	44.7	19.7	500	225	102	11.5	230	60	27.8	3550
			1136					8.6	460	60	13.9	3550
FH1111S47	37.5/550	150/166				227	103					
FH1112S47	37.5/600	150/180				229	104					
FH1113S50	37.5/655	150/198	46.0	20.9	532	247	112	13.8	230	60	31.6	3550
			1168					10.3	460	60	15.8	3550
FH1114S57	37.5/705	150/212	48.5	23.5	596	249	113					
			1232									
FH1115S57	37.5/755	150/230				251	114					



**Pressure Boosting Pumps**

series TH and FH use closed impellers in order to minimize power consumption and to optimize hydraulic pump efficiencies.

In addition, the TH series offers high pressures at short immersion depths. Inline pumps of the series FH can be used as boosting pumps if provided with positive inlet pressure. This inlet pressure can be provided by the central coolant supply or a feed pump. In such a setup, pumps of the series FH can raise the incoming pressure by up to 375 PSI (26 bar).

A frequency alternator can be supplied for special applications or for matching the pump characteristic to a specific duty point. See page "Control/Regulation" in the Technical Information section of this catalog for further information.

**Applications**

- Types of fluid
  - Industry water
  - coolants
  - cooling/cutting oils
- Kinematic viscosity
  - ...115 SSU (...25 mm<sup>2</sup>/s)
- Pumping temperature
  - 30...175 °F (0...80 °C)

**Construction**

Pump body	cast iron
Cover	cast iron
Impellers	CrNi-steel
Shaft	CrNi-steel
Diffusers	CrNi-steel
Mechanical seal	SiC
O-rings	Viton®
Noise level (Motor only; Tolerance +3 dBA)	
FH1102...FH1104	66 dBA
FH1105...FH1109	74 dBA
FH1110...FH1115	77 dBA

