

# Quick Suctioning Immersion Pumps

## TFL250...SFL1150

Axial/semi-open impellers

### TFL250

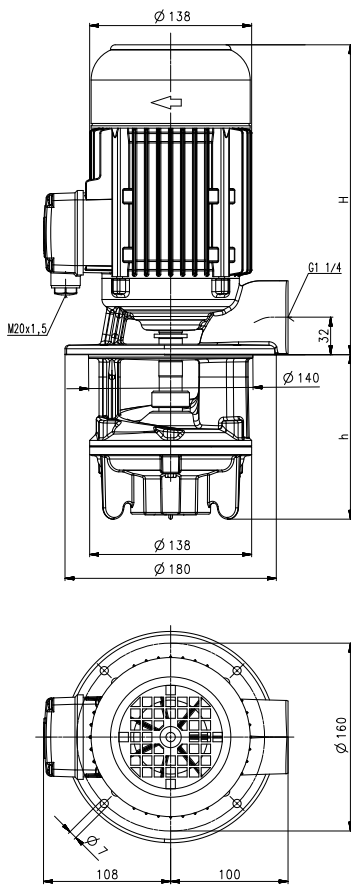

### SFL550...1150

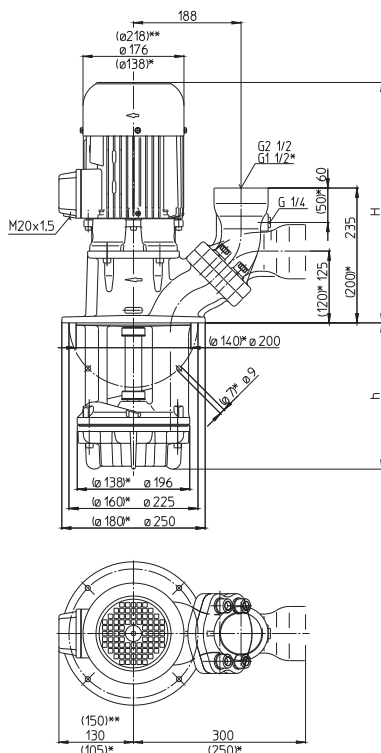

\*) Dimensions for SFL550  
 \*\*) Dimensions for SFL1150

Type	Vol. del. at manom. del. head l/min / m	Height H mm	Depth of immersion h mm	Weight kg	Power kW	Voltage 3 ~ V	Fre- quen- cy Hz	Current A	Speed 1/min
<b>TFL250/140</b>	150/4	264	140	14.5	0.63	220-240	50	2.70	2850
<b>220</b>			220	15.5					
<b>290</b>			290	16.5					
<b>370</b>			370	18.5	0.725	460	60	1.46	3425
<b>460</b>			460	19.5					
<b>570</b>			570	21.5					
<b>SFL550/150</b>	200/5	334	150	23	0.92	220-240	50	3.8	2840
<b>230</b>			230	24					
<b>300</b>			300	25					
<b>380</b>			380	27	1.06	460	60	2.1	3440
<b>470</b>			470	28					
<b>580</b>			580	30					
<b>SFL650/220</b>	400/8	464	220	51	2.2	220-240	50	7.8	2890
<b>320</b>			320	54					
<b>450</b>			450	57					
<b>570</b>			570	62	2.55	460	60	4.4	3480
<b>770</b>			770	73					
<b>1000</b>			1000	76					
<b>SFL850/230</b>	500/10	464	230	52	2.6	220-240	50	9.30	2880
<b>330</b>			330	55					
<b>460</b>			460	58					
<b>580</b>			580	65	2.94	460	60	5.1	3480
<b>780</b>			780	75					
<b>1010</b>			1010	78					
<b>SFL1150/230</b>	600/10	503	230	62	4.0	220-240	50	14.50	2920
<b>330</b>			330	66					
<b>460</b>			460	73					
<b>580</b>			580	76	4.55	460	60	7.9	3520
<b>780</b>			780	85					
<b>1010</b>			1010	88					

### Quick Suctioning Immersion Pumps

series TFL/SFL equipped with the patented "BRINKMANN's Suction De-aeration System" are excellently suited to pumping **extremely air entrained fluids** (emulsions) with **heavy chip loads** as they occur in heavy cutting when turning, milling or grinding.

The quick suctioning immersion pumps reach stable working conditions as soon as the liquid level reaches the suction inlet.

The SFL serie offers a **flange** with pressure gauge connection port.

The flange can be rotated for either horizontal or vertical pipe connections.

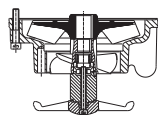

These pumps are available (upon request) with an additional agitator at the pump suction for breaking up and separating large bundles of chips.

### Applications

Types of fluid  
coolants  
cooling/cutting oils  
Max. chip to coolant ratio by weight:  
1.0 %  
Chip material:  
Aluminium, steel, coloured steels  
Kinematic viscosity  
...45 mm<sup>2</sup>/s (45 cSt)  
Pumping temperature  
0...80° C

### Construction

Pump body	cast iron
Cover	cast iron
Impeller axial	cast steel
Impeller radial	cast steel
Shaft	steel
Optional:	
Pump unit	with wear resistant wetted parts
Execution CM1	
Impeller radial	CrMo-steel
Execution CM3	
Cover	CrMo-steel
Impeller axial	CrMo-steel
Impeller radial	CrMo-steel

