

# Pressure Boosting Pumps

## FH11

Closed impellers



### FH1102...1115

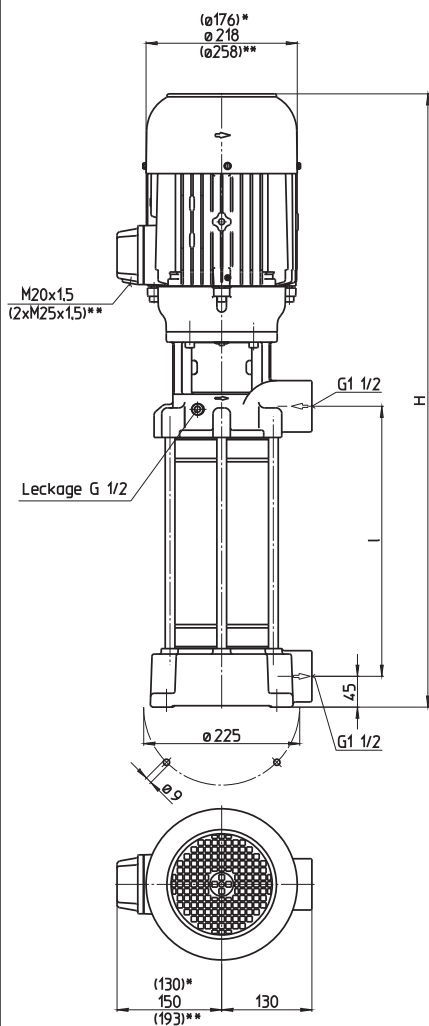

\*) Dimensions for FH1102...1104  
 \*\*) Dimensions for FH1110...1115

Type	Vol. del. at manom. del. head l/min / m	Height H mm	Length l mm	Weight kg	Power kW	Voltage 3~ V	Fre- quen- cy Hz	Current A	Speed 1/min
<b>FH1102B18</b>	150/30	643	212	39	1.49	460	60	2.7	3500
<b>FH1103B18</b>	150/45	702	212	46	2.18	460	60	3.9	3500
<b>FH1104B28</b>	150/59	798	308	47	2.94	460	60	5.1	3480
<b>FH1105B28</b>	150/77	837	308	60	3.8	460	60	6.4	3520
<b>FH1106B28</b>	150/90	837	308	62	4.55	460	60	7.9	3520
<b>FH1107B31</b>	150/106	899	340	67	5.75	460	60	9.5	3520
<b>FH1108B38</b>	150/121	963	404	69					
<b>FH1109B38</b>	150/138	963	404	71	6.3	460	60	10.4	3510
<b>FH1110B47</b>	150/152	1136	500	102	8.6	460	60	13.7	3550
<b>FH1111B47</b>	150/166			103					
<b>FH1112B47</b>	150/180			104					
<b>FH1113B50</b>	150/198	1168	532	112	10.3	460	60	15.8	3550
<b>FH1114B57</b>	150/212	1232	596	113					
<b>FH1115B57</b>	150/230			114					

**Pressure Boosting Pumps**

series TH and FH use **closed impellers** in order to minimize power consumption and to optimize hydraulic pump efficiencies.

In addition, the TH series offers high pressures at short immersion depths. Inline pumps of the series FH can be used as **boosting pumps** if provided with positive inlet pressure. This inlet pressure can be provided by the central coolant supply or a feed pump. In such a setup, pumps of the series FH can raise the incoming pressure by up to 26 bar.

A **frequency converter** can be supplied for **special applications** or for matching the pump characteristic to a specific duty point.

See page "Control/Regulation" in the Technical Information section of this catalog for further information.



**Applications**

- Types of fluid
  - Industry water
  - coolants
  - cooling/cutting oils
- Kinematic viscosity
  - ...25 mm<sup>2</sup>/s (25 cSt)
- Pumping temperature
  - 0...80° C

**Construction**

Pump body	cast iron
Cover	cast iron
Impellers	CrNi-steel
Shaft	CrNi-steel
Diffusers	CrNi-steel
Mechanical seal	SiC
O-rings	Viton
<b>Noise level</b>	
FH1102...FH1104	66 dBA
FH1105...FH1109	74 dBA
FH1110...FH1115	77 dBA

